

ALE

Washable

RoHS Compliant

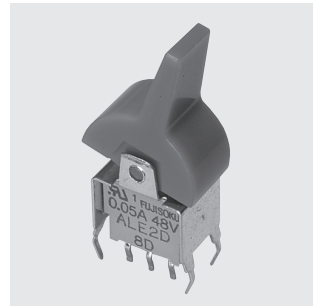

Standard Lever & Rocker Switches

UL

■ Features

- High reliability**
The twin-contact clip mechanism is employed for the contact section to ensure high reliability.
- Process sealed structure**
All types of the switch feature the completely sealed structure.
- Designed for dry circuit applications**
Since the contacts are gold-plated, the switches are best suited for use in the dry circuit areas.
- Designed for PC board applications**
The terminal pitches are all in inch size (2.54 mm).
- Improved operability**
The independent detent structure provides a light operating touch.
- All models are of UL approved type.

■ Specifications

Rating	Max : 0.4 VA (60 VAC/DC 50 mA) Min:1μA 20 mVAC/DC UL:48 VAC/DC 50 mA
Initial contact resistance	50 mΩ max. (1.5 mA 200 μVAC)
Dielectric strength	250 VAC 1 minute
Insulation resistance	500 MΩ min. (500 VDC)
Electrical life	10,000 cycles at maximum rating 50,000 cycles at 0.4 VA min. (D,E type) 30,000 cycles at 0.4 VA min. (F,G type)
Operating temperature range	-20~+85°C
Storage temperature range	-40~+85°C

■ Part Numbering

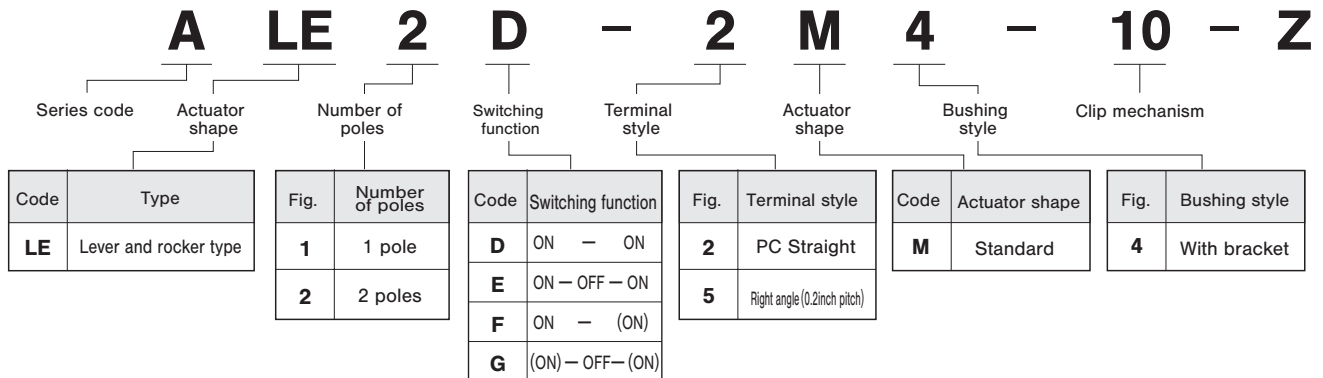

Terminal line for double poles are 2.54mm (0.1")

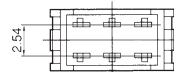

■ Actuator Shape

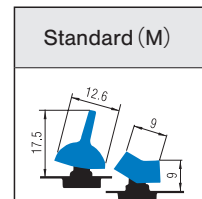

Note : Some model names may not be registered. Please refer to the product list for this series.

ALE

SPDT

PC Straight

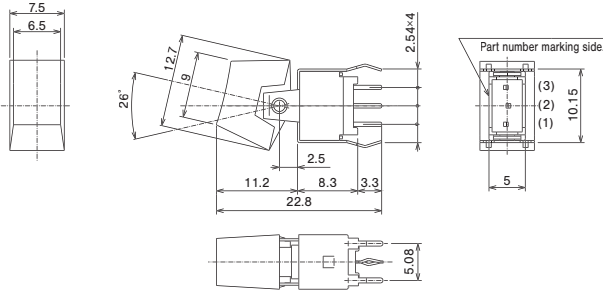
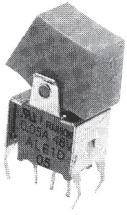

(Mount with Rocker)

Terminal numbers are not shown on the bottom of the switch.

Switching function	Viewed from part No. and rating marking side		
Part No.			
UL ALE1D-2M4-10-Z	ON	—	ON
UL ☆ALE1E-2M4-10-Z	ON	OFF	ON
UL ☆ALE1F-2M4-10-Z	ON	—	(ON)
UL ☆ALE1G-2M4-10-Z	(ON)	OFF	(ON)
Connecting terminals	2-3	—	2-1

DPDT

PC Straight

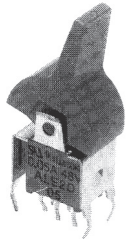

Distance between two terminal rows : 2.54 mm

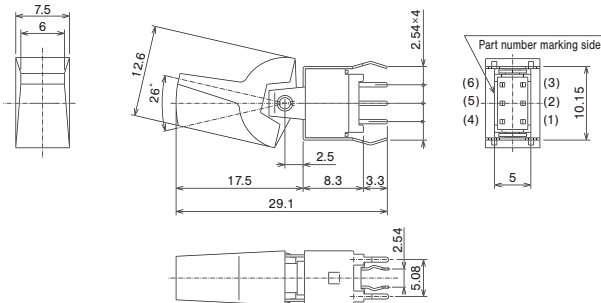

(Mount with Lever)

Terminal numbers are not shown on the bottom of the switch.

Switching function	Viewed from part No. marking side		
Part No.			
UL ☆ALE2D-2M4-10-Z	ON	—	ON
Connecting terminals	2-3 5-6	—	2-1 5-4

SPDT

0.2R/A

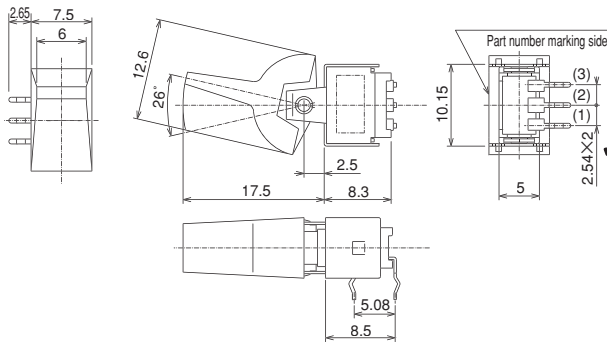
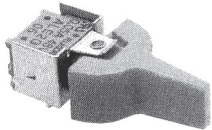

(Mount with Lever)

Terminal numbers are not shown on the bottom of the switch.

Switching function	Viewed from part No. marking side		
Part No.			
UL ☆ALE1D-5M4-10-Z	ON	—	ON
Connecting terminals	2-3	—	2-1

DPDT

0.2R/A

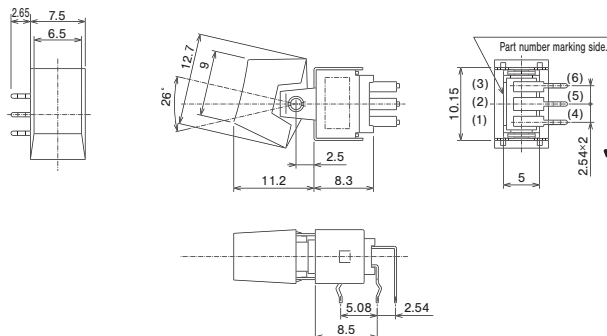
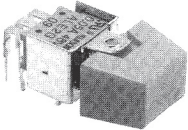

(Mount with Rocker)

Terminal numbers are not shown on the bottom of the switch.

Switching function	Viewed from part No. marking side		
Part No.			
UL ☆ALE2D-5M4-10-Z	ON	—	ON
Connecting terminals	2-3 5-6	—	2-1 5-4

Table of Part Numbers and UL listed

Poles	Part number	Switching function	UL (※1)
1 pole	ALE1D-2M4-10-Z	ON - ON	
	ALE1D-5M4-10-Z	ON - ON	
	ALE1E-2M4-10-Z	ON -OFF- ON	
	ALE1F-2M4-10-Z	ON - (ON)	
	ALE1G-2M4-10-Z	(ON) -OFF- (ON)	
2 poles	ALE2D-2M4-10-Z	ON - ON	
	ALE2D-5M4-10-Z	ON - ON	

(※1) UL File No. E43275

(ON) : Momentary ☆ : Semi-standard products.

